



PIPE JACK STAND
Model JPJ-5LG-SR
OPERATING INSTRUCTIONS AND PARTS MANUAL



1 Introduction

1.1 JET TOOLS®

Congratulations on purchasing this quality JET product. JET Tools is committed to being the supplier you can depend on for the highest quality products, superior innovation, and outstanding customer service. For more than 50 years, JET tool products have been used by manufacturing professionals in plants, machine shops, and workshops across the United States. We are also proud to serve the prosumer and hobbyist workshops everywhere.

This manual covers the safe operation and maintenance procedures for the JET pipe jack stand. This manual contains instructions on safety precautions, assembly, general operating procedures, maintenance instructions, and replacement parts. This tool is designed and constructed to provide consistent, long-term operation if used in accordance with instructions contained in this manual.

If you have any questions or comments, please contact either your local supplier or JET Tools. JET Tools can also be reached at our web site: www.jettools.com.

Contact the Factory:

JET Tools
427 New Sanford Road
La Vergne, TN 37086
Phone: 800.274.6848
www.jettools.com

1.2 PRODUCT IDENTIFICATION

JET pipe jack stand model JPJ-5LG-SR is serialized for quality control, production traceability, and warranty enforcement. When ordering parts or filing a warranty claim, please refer to the identification label on the pipe jack stand with model number, stock number, and serial number. Fill in the information below for easy recall when needed.

Model Number:	_____
Stock Number:	_____
Serial Number:	_____
Date Purchased:	_____
Where Purchased:	_____

1.3 PRODUCT REGISTRATION

There are two ways you can register this product with JET Tools.

1. Register online at jettools.com/product-registration.
2. Scan the QR code below under *1.4 PRODUCT LANDING PAGE*. There, you will find a product registration link.

1.4 PRODUCT LANDING PAGE

Scan the QR code below to go to the product landing page. There, you can register your product and find more information about the product.



1.5 SIGNAL WORD DEFINITIONS

DANGER

Indicates a hazardous situation that, if not avoided, will result in death or serious injury.

WARNING

Indicates a hazardous situation that, if not avoided, could result in death or serious injury.

CAUTION

Indicates a hazardous situation that, if not avoided, could result in mild to moderate injury and/or property damage.

NOTICE

Indicates information considered important but not hazard related.

2 Safety Information

WARNING

Read and understand this entire owner's manual before using this pipe jack stand. Failure to comply with instructions and safety warnings in this manual and on the stand may cause serious injury or death.

General Safety Warnings

1. This pipe jack stand is designed and intended for use by properly trained and experienced personnel only. Learn how to operate this pipe jack stand properly and safely. If you are not familiar with the proper and safe operation, do not use it. Follow proper and safe practices.
2. When using this pipe jack stand, wear proper clothing and safety gear. Wear a hard hat, safety glasses, steel-toe shoes, gloves and other appropriate gear for the job.
3. Do not alter or modify the pipe jack stand. Use only as intended. Only use replacement parts and accessories approved and provided by JET.

Inspection and Maintenance

1. Inspect the pipe jack stand for damage prior to each use. Check for bent, broken, damaged, and missing parts, including legs and adjustment mechanisms. If stand is damaged or parts are missing, remove from service and only use replacement parts approved and provided by JET. If the damaged or missing part is not offered as a replacement part, do not attempt to repair. Permanently remove pipe jack stand from service. For examples of damage, see *Section 7 Inspect for Damage*.

Operation Warnings

1. Do not exceed the rated load capacity of this pipe jack stand. The maximum load capacity is 2500 lbs.
2. Use pipe jack stands only on solid and level surfaces that will support the weight of the load. Do not use on inclines. Avoid dirt or gravel surfaces. Make sure all wheels of each stand make solid contact with the floor surface.
3. Always lock all five caster wheels on each stand before adding the load.
4. Always support pipe with at least two stands to ensure stability. Make sure the stands are the same height and properly spaced to support the load evenly and ensure the load will not tip or move. Consider the pipe length, diameter, and weight when deciding the number of stands needed.
5. Use the same pipe jack stand height and head styles for each load to maintain balance and safety.
6. Properly position the load. Center the load on the pipe jack heads. Never place more than one pipe on pipe jack stands.
7. Adjust the pipe jack stand height before adding the load.
8. Do not drop a load onto stand. Gently position load on stand.
9. When positioning load on stand, do not place your hands or any body part between the load and the stand head and rollers.
10. Never allow anyone beneath a supported load.
11. Never adjust the height while under load. Remove load and adjust stand height.
12. If transporting a load, you must first safely secure the load to the stands. Follow instructions in *Section 6 Operation*.
13. If load becomes unstable, do not reach out to try and stabilize or catch the load. Quickly move away from the work area.

3 Product Identification



4 Specifications

Model Number	JPJ-5LG-SR
Stock Number	JT1-2405
Max. Load Capacity	2500 lbs.
Adjustable Height Range	34 to 46 in.
Screw Shaft Diameter	1-3/4"
Pipe Diameter Range	1/2 to 36 in.
Overall Dimensions	39 x 39 x 40-1/4 in.
Weight	124 lbs.
Head Type	Steel Rollers

5 Assembly

Model JPJ-5LG-SR

Refer to *Section 3 Product Identification* and Figures 4-1 and 4-2 for parts and locations.

1. Locate the pipe jack frame, five caster wheels, and roller head assembly.
2. For each caster wheel, insert the caster post into the caster mounting cylinder at the end of each frame leg. Tighten the caster post locking set screw to hold the caster wheel in place.
3. Insert the roller head assembly down into the base cylinder.

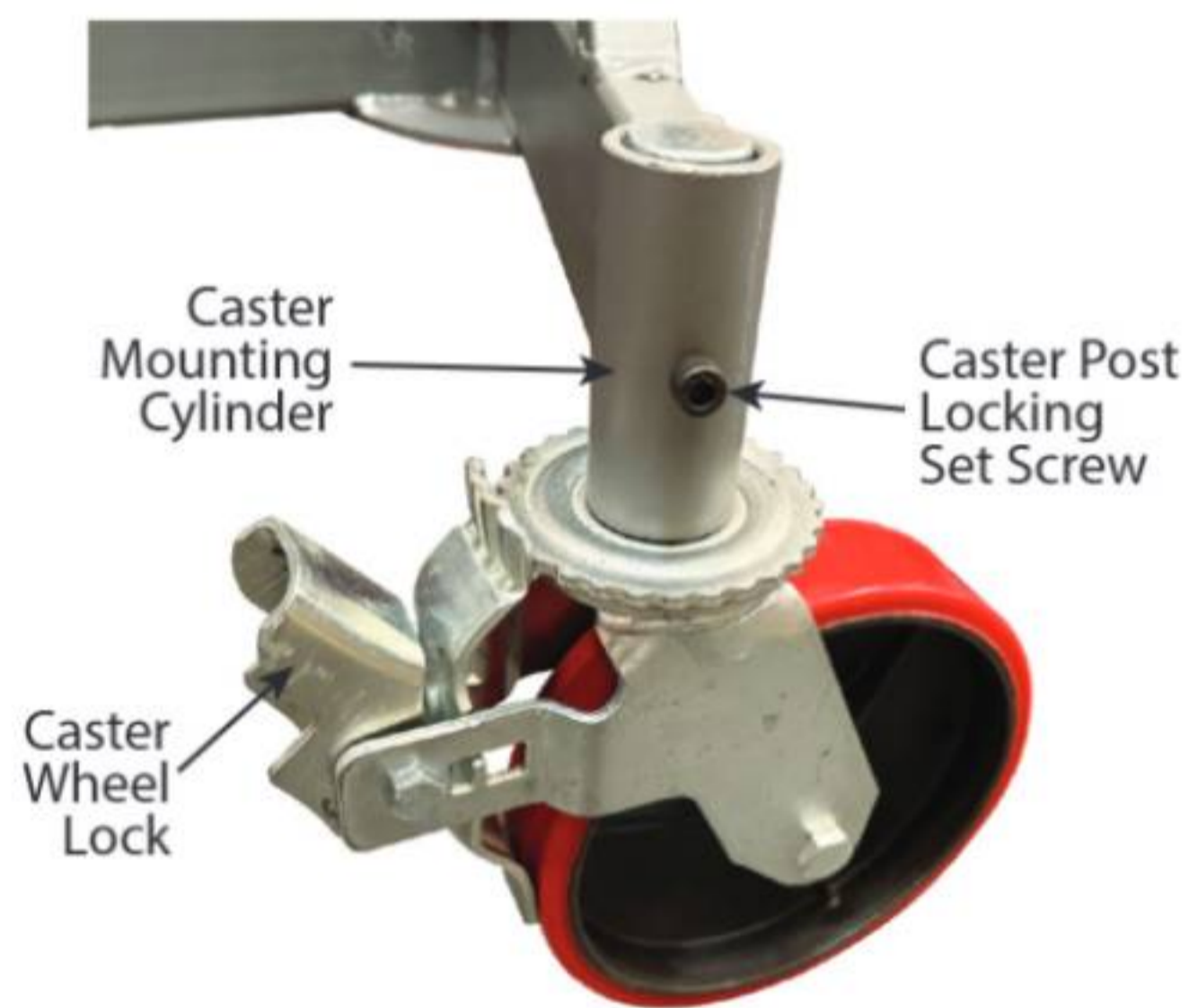

Figure 4-1: Installing Caster Wheels

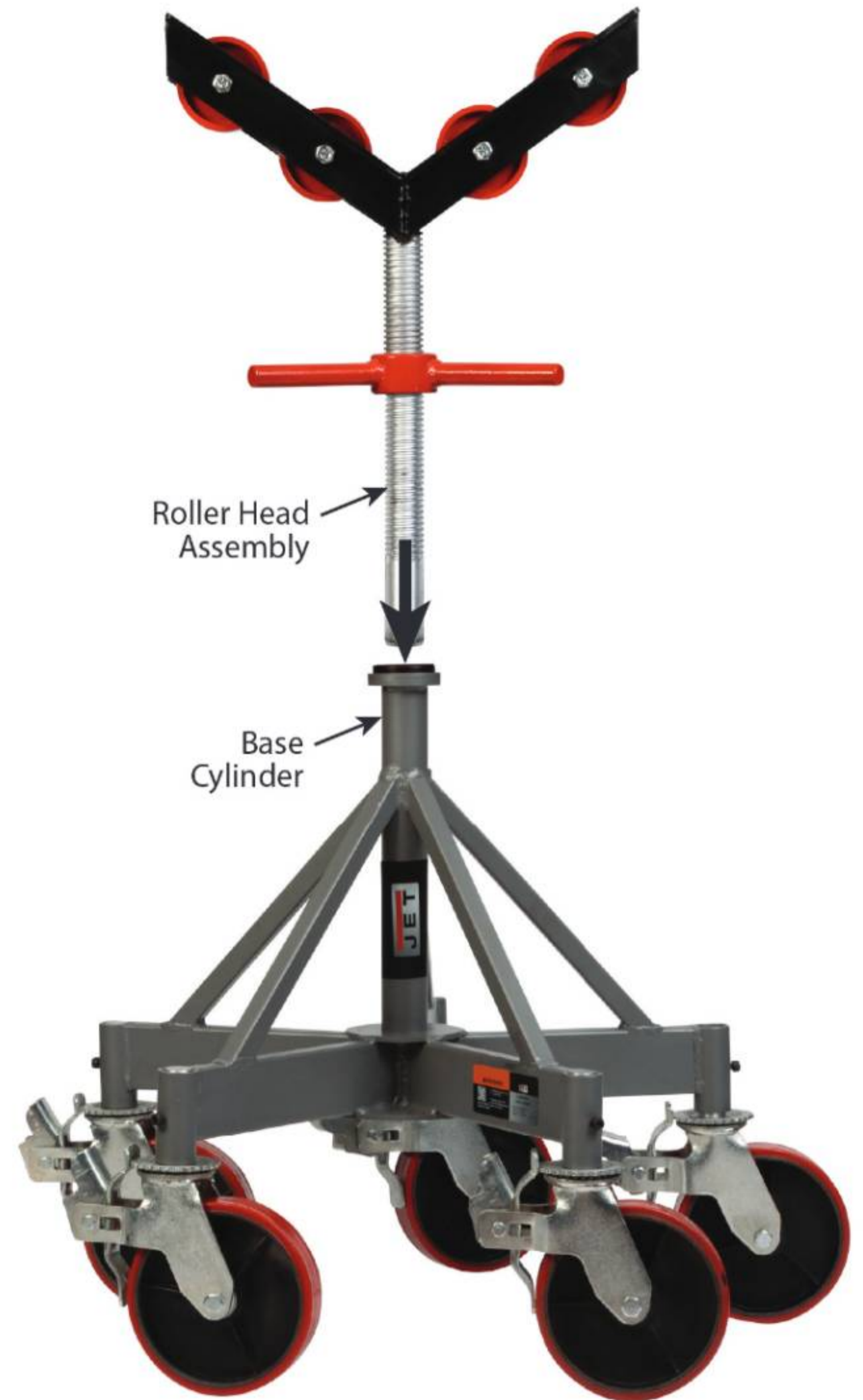

Figure 4-2: Insert Roller Head Assembly into Base Cylinder

6 Operation

WARNING

Read and understand this entire owner's manual before using this pipe jack stand. Failure to comply with instructions and safety warnings in this manual and on the stand may cause serious injury or death.

WARNING

Inspect the pipe jack stand for damage prior to each use. Check for bent, broken, damaged, and missing parts, including legs and adjustment mechanisms. If stand is damaged or parts are missing, remove from service and only use replacement parts approved and provided by JET. If the damaged or missing part is not offered as a replacement part, do not attempt to repair. Permanently remove pipe jack stand from service. For examples of damage, see *Section 7 Inspect for Damage*.

Important: Refer to *Section 3 Product Identification* for parts and locations.

Operating Pipe Jack Stands

WARNING

Always support pipe with at least two stands to ensure stability. Make sure the stands are the same height and properly spaced to support the load evenly and ensure the load will not tip or move. Consider the pipe length, diameter, and weight when deciding the number of stands needed.

1. Place pipe jack stands on a solid and level surface that will support the weight of the load. Make sure all wheels of each stand make solid contact with the floor.
2. Unlock all five casters of each stand and point the wheels in the same direction.
3. With no load on each stand, turn the three-spoke spanner nut to raise or lower the roller head assembly to the desired height.
4. Gently place the pipe onto the stands. Do not drop load onto the stands. Do not exceed the maximum load capacity for each stand. Make sure the load is centered on the pipe jack head. Never place more than one pipe on the pipe jack stands.

WARNING

Never allow anyone beneath a supported load.

Transporting A Load

WARNING

You must secure the load to the pipe jack stands before moving to a new location. Only move load on a solid and level surface that will support the weight of the load. Do not move on inclines or on surfaces that are rough, earthen, or gravel. Make sure all five wheels of each stand make constant and full contact with the floor surface.

You may move a load by rolling the jack stands to a new location. Before doing so, you must secure the load to the pipe jack stands. Make sure you know how to properly attach and secure your hold-down device before attempting to secure and move the load.

Follow the steps below to safely secure and move a load.

1. Make sure all five caster wheels are locked on each pipe stand.
2. Attach your hold-down device to the hold-down device attachment point at the bottom of the roller head.
3. Wrap the pipe with the hold-down device and attach it back to itself. Tighten hold-down device until the pipe is firmly attached to each pipe stand with no slippage.
4. Unlock all five casters wheels on each pipe stand. Rotate the pipe stand bases in a circular motion in order to align the casters. Push or pull the load from the end to the desired location.

WARNING

Do not stand or walk to the side of a load while transporting.

7 Inspect for Damage

WARNING

Inspect the pipe jack stand for damage prior to each use. Check for bent, broken, damaged, and missing parts, including legs and adjustment mechanisms. If stand is damaged or parts are missing, remove from service and only use replacement parts approved and provided by JET. If the damaged or missing part is not offered as a replacement part, do not attempt to repair. Permanently remove pipe jack stand from service.

- A. Legs/base show signs of fatigue, twisting, or bending. This prevents full ground contact and compromises structural strength.
- B. Fasteners at the head assembly are missing, loose, or show signs of wear. This will compromise structural integrity.
- C. Welds or parts show visible rust, cracks, or signs of fatigue. Corroded or cracked areas are prone to sudden failure.
- D. Wheel tread becomes damaged. This will prevent the pipe jack stand from moving smoothly and can cause the load to shift, tilt, and fall.
- E. One or more caster wheels are missing. This will cause the stand to be unstable and tilt under load.
- F. The head assembly tilts or rotates under load, which may indicate damaged welds or worn locking components. This may cause pipe to slip, roll, or fall.
- G. Steel rollers are jammed, worn flat, or fail to rotate smoothly. This can cause uneven loading and operational hazards.

NOTE: Images below show some, but not all, damage examples.



8 Replacement Parts

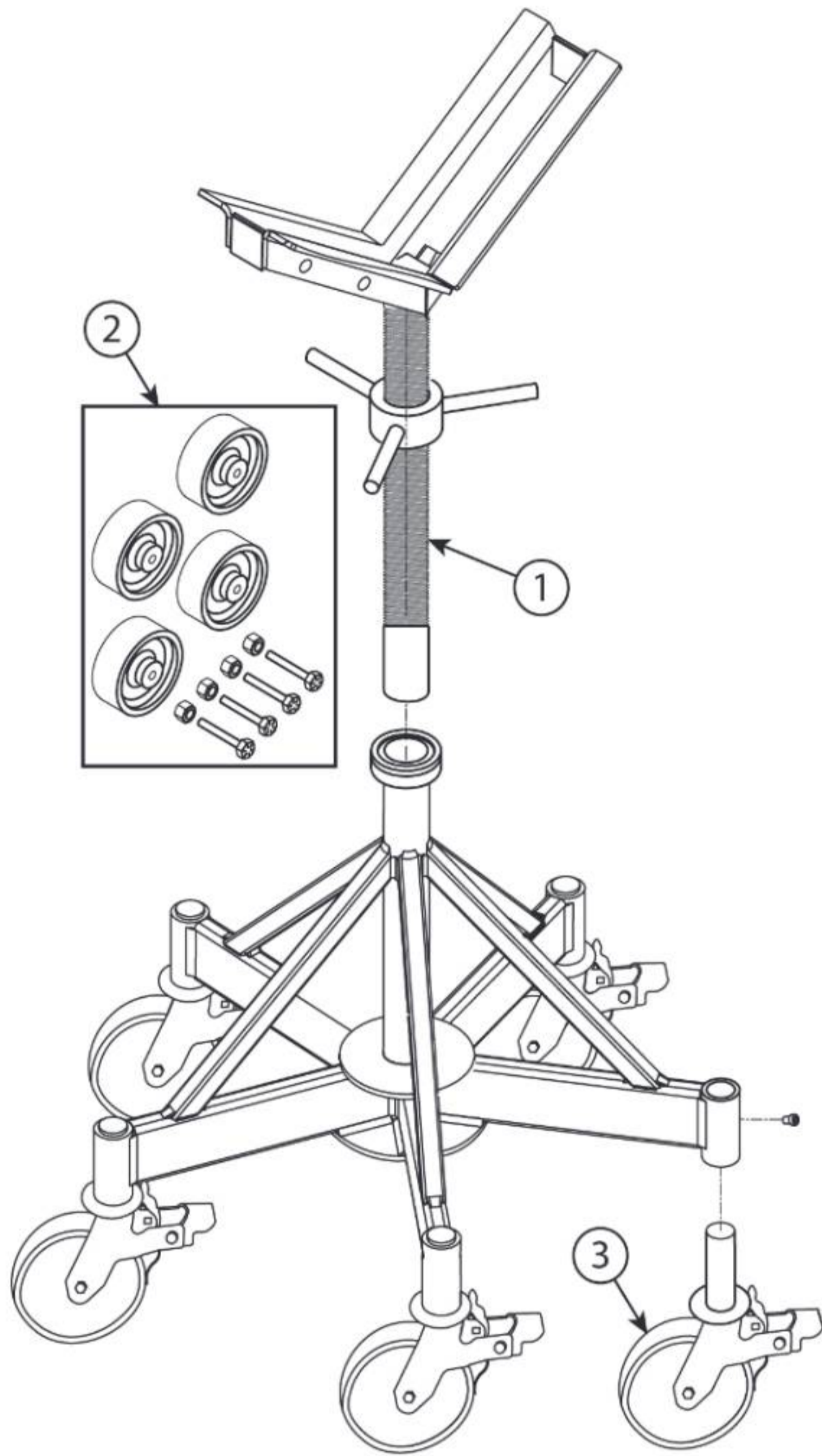

Item	Part No.	Description	Qty.
1	JT1-2585	Roller Head Assy. (without rollers)	1
2	JT1-2584	Steel Rollers with Grease Bolt Axles and Wingnuts (set of 4)	1
3	JT1-2583	Casters with Set Screws (set of 5)	1

9 Warranty

JET warrants every product it sells against manufacturers' defects. If one of our tools needs service or repair, please contact Technical Service by calling 1-800-274-6846, 8AM to 5PM CST, Monday through Friday.

Warranty Period

The general warranty lasts for the time period specified in the literature included with your product or on the official JET branded website.

- JET products carry a limited warranty which varies in duration based upon the product. (See *Product Listing with Warranty Period*, below)
- Accessories carry a limited warranty of one year from the date of receipt.
- Consumable items are defined as expendable parts or accessories expected to become inoperable within a reasonable amount of use and are covered by a 90-day limited warranty against manufacturer's defects.

Who is Covered

This warranty covers only the initial purchaser of the product from the date of delivery.

What is Covered

This warranty covers any defects in workmanship or materials subject to the limitations stated below. This warranty does not cover failures due directly or indirectly to misuse, abuse, negligence or accidents, normal wear-and-tear, improper repair, alterations, or lack of maintenance. JET woodworking machinery is designed to be used with Wood. Use of these machines in the processing of metal, plastics, or other materials may void the warranty. The exceptions are acrylics and other natural items that are made specifically for wood turning.

Warranty Limitations

Woodworking products with a Five-Year Warranty that are used for commercial or industrial purposes default to a Two-Year Warranty. Please contact Technical Service at 1-800-274-6846 for further clarification.

How to Get Technical Support

Please contact Technical Service by calling 1-800-274-6846. Please note that you will be asked to provide proof of initial purchase when calling. If a product requires further inspection, the Technical Service representative will explain and assist with any additional action needed. JET has Authorized Service Centers located throughout the United States. For the name of an Authorized Service Center in your area call 1-800-274-6846 or use the Service Center Locator on the JET website.

More Information

JET is constantly adding new products. For complete, up-to-date product information, check with your local distributor or visit the JET website.

How State Law Applies

This warranty gives you specific legal rights, subject to applicable state law.

Limitations on This Warranty

JET LIMITS ALL IMPLIED WARRANTIES TO THE PERIOD OF THE LIMITED WARRANTY FOR EACH PRODUCT. EXCEPT AS STATED HEREIN, ANY IMPLIED WARRANTIES OF MERCHANTABILITY AND FITNESS FOR A PARTICULAR PURPOSE ARE EXCLUDED. SOME STATES DO NOT ALLOW LIMITATIONS ON HOW LONG AN IMPLIED WARRANTY LASTS, SO THE ABOVE LIMITATION MAY NOT APPLY TO YOU.

JET SHALL IN NO EVENT BE LIABLE FOR DEATH, INJURIES TO PERSONS OR PROPERTY, OR FOR INCIDENTAL, CONTINGENT, SPECIAL, OR CONSEQUENTIAL DAMAGES ARISING FROM THE USE OF OUR PRODUCTS. SOME STATES DO NOT ALLOW THE EXCLUSION OR LIMITATION OF INCIDENTAL OR CONSEQUENTIAL DAMAGES, SO THE ABOVE LIMITATION OR EXCLUSION MAY NOT APPLY TO YOU.

JET sells through distributors only. The specifications listed in JET printed materials and on official JET website are given as general information and are not binding. JET reserves the right to effect at any time, without prior notice, those alterations to parts, fittings, and accessory equipment which they may deem necessary for any reason whatsoever. JET® branded products are not sold in Canada by JPW Industries, Inc.

Product Listing with Warranty Period

90 Days – Parts; Consumable items

1 Year – Motors; Machine Accessories

2 Year – Metalworking Machinery; Electric Hoists, Electric Hoist Accessories; Mobile Material Lifts; Pipe Jack Stands; Woodworking Machinery used for industrial or commercial purposes

5 Year – Woodworking Machinery

Limited Lifetime – JET Parallel clamps; VOLT Series Electric Hoists; Manual Hoists

Accessories; Shop Tools; Warehouse & Dock products; Hand Tools; Air Tools

NOTE: JET is a division of JPW Industries, Inc. References in this document to JET also apply to JPW Industries, Inc., or any of its successors in interest to the JET brand.



JET TOOLS

427 New Sanford Road
LaVergne, Tennessee 37086
Phone: 800-274-6848

www.jettools.com